



**Media Statement**  
*For immediate release*

**TRAFFIC ANNOUNCEMENT**  
**LANE CLOSURE AT PERSIARAN DATO' MENTERI, SHAH ALAM**

<b>Date</b>	<b>24 January to 1 February, 2018</b>
<b>Time</b>	<b>10:00 p.m. - 5:00 a.m.</b>
<b>Duration</b>	<b>7 days</b>
<b>Reason</b>	<b>To facilitate piloting work for LRT3 at Persiaran Dato' Menteri, Shah Alam (left lane) before Persiaran Damai intersection traffic light until the entrance of Pejabat Pos Besar Shah Alam.</b>

**SHAH ALAM, SELANGOR - 22 January, 2018:** MRCB George Kent, the Project Delivery Partner (PDP) of the Light Rail Transit 3 (LRT3) project, wishes to inform that there will be a lane closure at Persiaran Dato' Menteri from 24 January to 1 February 2018. The lane closure will start before Persiaran Damai intersection traffic light until the entrance of Pejabat Pos Besar Shah Alam.

The 1.5 kilometres lane closure is to facilitate the LRT3 piloting works in the area and closure will commence from 10 p.m. until 5 a.m. the next day. Normal traffic flow will be restored before the morning peak hours.

In the event of inclement weather, untimely execution of the piloting works is expected.

The closure and work areas are shown in the map below.

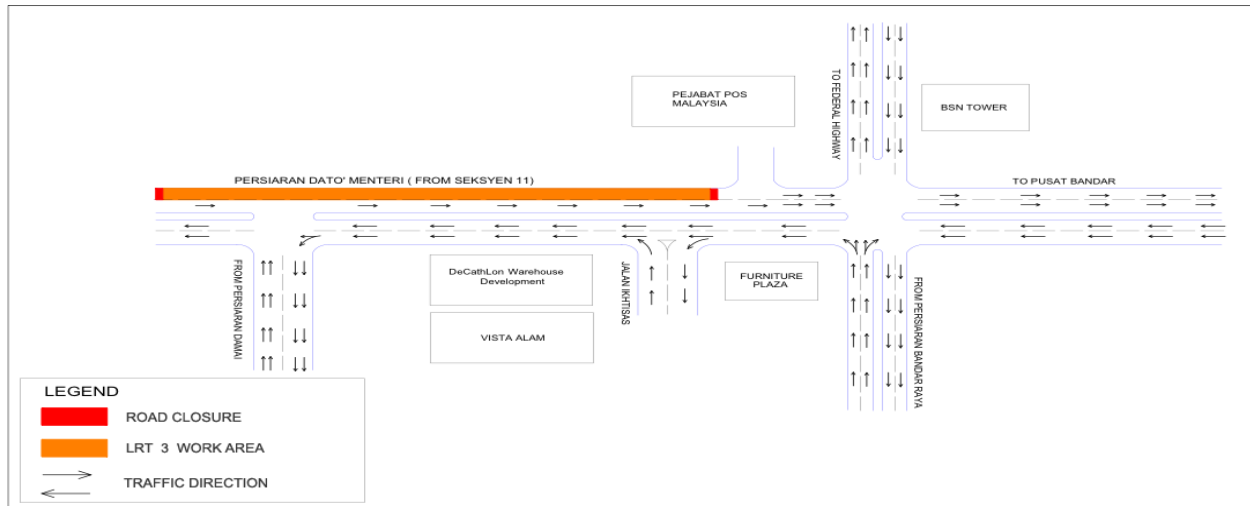

We apologise for any inconvenience caused to the public.

For public enquiries, kindly contact LRT3 hotline at 1 800 18 2585.

--ENDS--

For media enquiries, contact:

Ivlynn Yap  
Specialist, PR & Communications  
MRCB George Kent Sdn Bhd  
03-5033 6857  
[Ivlynn.yap@mrcbgk.com](mailto:Ivlynn.yap@mrcbgk.com)

Nur Adlina Abu Bakar  
WPC PR & Stakeholder Management  
012-689 9677  
[adlina@apex.com.my](mailto:adlina@apex.com.my)



### **ABOUT MRCB GEORGE KENT (MRCB GK)**

MRCB George Kent Joint Venture (MRCB George Kent) was appointed on 4th September 2015 as the Project Delivery Partner (PDP) of the Light Rail Transit 3 (LRT3).

MRCB is currently the largest developer cum contractor of Transit Oriented Developments (TODs) in Malaysia, while George Kent is the largest home-grown railway system specialist in Malaysia.

MRCB George Kent brings to the LRT3 project a highly-skilled and professional staff pool experienced in transit projects, with tailored and cost-effective solutions specific to Prasarana's needs in a collaborative and supportive manner.

### **ABOUT THE LIGHT RAIL TRANSIT LINE 3 (LRT3)**

The LRT3 envisages to connect 2 million people between Bandar Utama and Klang by 2020. Developed in line with Greater Kuala Lumpur/ Klang Valley (GKL/KV) Land Public Transport Masterplan, LRT3 will be a key feature in extending rail connectivity to the Western Corridor of GKL/KV. For more information, visit [www.lrt3.com.my](http://www.lrt3.com.my) and follow [@myLRT3](https://twitter.com/myLRT3)